

Storm

Luxury Vinyl Planks

INSTALLATION INSTRUCTIONS

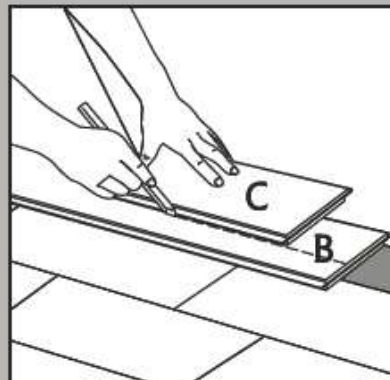
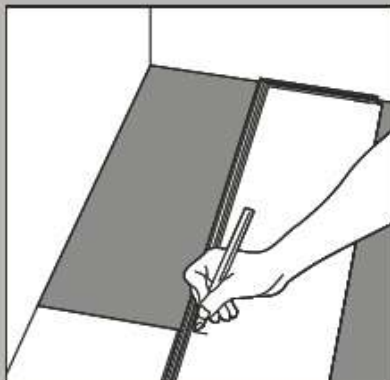
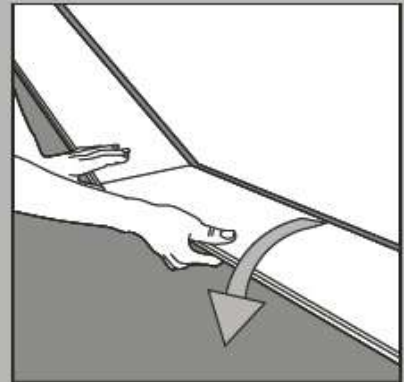
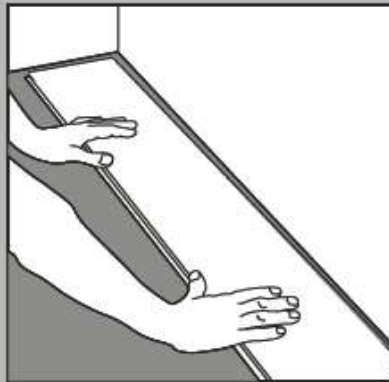
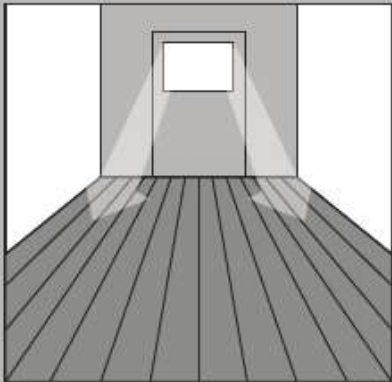

TOOLS REQUIRED

- Utility Knife
- Straight Edge
- Tape Measure & T Square
- Spacers

PRIOR TO INSTALLATION

- Carefully check flooring material for any defects.
- Room temperature should be no less than 18°C for 24 hours before, during and after installation.
- Remove all quarter round, baseboard moulding or cove base.
- Undercut doorway moulding according to the thickness of the flooring.
- Cartons must be stored horizontally at all times.
- Protect carton corners from damage.

SUBSTRATE PREPARATION

- All substrates must be dry, clean, smooth, level and free from all existing adhesive residues and free from movement or deflection.
- The substrate must be level within 4.7mm in 3.00m.
- Fill and level all seams and cracks, construction joints, control joints, depressions, grooves or other irregularities.
- Sweep and/or vacuum substrate to remove all dust and debris.

GETTING STARTED

- Storm is a floating floor and should not be glued or nailed to the substrate.
Storm is intended for indoor use only. To make the room appear longer, if installing in small rooms or corridors, it is preferable to lay the planks parallel to the longest room dimension.
- Do not install cabinets on your Multi-Click flooring. Install flooring around cupboards and use moulding.
- Carefully measure the room to determine the dimensions and also what the width of the last row of planks will be. If the width of the last row of planks is less than 50mm (excluding the tongue) the width of the first row of planks will have to be cut accordingly.
- A minimum of 8.2mm expansion space is required around the perimeter of the room and all vertical objects.
- Inspect all the planks for visible defects and damage before and during installation. Do not install damaged planks. Storm will not accept responsibility for claims on flooring installed with obvious defects. During installation, inspect the groove area and remove any debris that may prevent proper assembly of planks.

INSTALLATION

- Begin laying planks from the left side of the starting wall and work to the right side. The tongue side of the plank must face the starting wall.
- Place an 8.2mm spacer between the short and long side of the planks and the wall. Always position one spacer between the wall and where the planks join.
- The end joints of the planks in the first row are assembled by inserting the tongue side into the groove side of the previous plank at a low angle. Gradually lower the plank down flat until the end joint closes, insuring that the planks are perfectly aligned. Install the remaining full planks in the first row.
- The plank in the first row will need to be cut. Measure the distance between the wall and the surface of the last full plank. Subtract 8.2mm from this measurement to allow for the spacer.
- If this measurement is less than 20.3cm the length of the first plank in the row must be cut. This will allow for a longer plank at the end of the row.
- The first plank in each row must be at least 20.3cm in length.
- Planks should be cut using a sharp utility knife and straight edge / carpenters square. Score the surface of the plank with a utility knife and then snap the plank at the score line.
- The remaining piece cut off from the last plank in the first row may serve as the first plank in the second row, provided it is at least 20.3cm long. Always use cut edges on the outside edges to be covered by moulding to improve appearance.
- Install the long side of the first plank of the second row. Remember to place the 8.2mm spacer between the wall and the short side of the plank. Insert the tongue side into the groove side of the previous row at a low angle and lower it onto the substrate.
- Install the second plank in the second. Position the long side of the plank with the tongue side overlapping the groove of the planks in the previous row marginally. Then, angle the end joint into the previous plank. Angle the plank up and gently push forward until the plank locks into the previous row. Continue installing the remaining planks in the second row. It is important to ensure the first two rows are straight and square as they will affect the entire installation.
- Continue working left to right, row by row. Be sure to maintain an 8.2mm space around all walls and vertical objects and an offset of 20.3cm.

FINISHING THE INSTALLATION

- After all the planks have been installed, remove spacers from the perimeter of the room.
- Install transition mouldings. Do not fasten any moldings through the flooring.
- Pre drill and install quarter round or baseboard moulding. Molding must be sufficient size to cover the 8.2mm space. Do not fasten mouldings through the flooring, fasten to the wall.
- Use plywood to cover the top of the flooring when moving heavy furniture or appliances into position.
- Use proper floor protectors under the legs of the furniture.
- Post installation temperature must be maintained between 18 - 36°C and relative humidity must be maintained between 40 - 70%.